



Office of Engineering
PO Box 94245 | Baton Rouge, LA 70804-9245
ph: 225-379-1234 fx: 225-379-1851

John Bel Edwards, Governor
Shawn D. Wilson, Ph.D., Secretary

PUBLIC NOTICE

NAVIGATIONAL CLEARANCE DETERMINATION TO REPLACE THE EXISTING US 90 VERTICAL LIFT BRIDGE (RECALL NUMBER 058710) WITH A NEW FIXED BRIDGE CROSSING WEST PEARL RIVER, MILE 7.9, ST. TAMMANY PARISH, LOUISIANA

All interested parties are notified that the Louisiana Department of Transportation and Development (LA DOTD) is proposing to build a new US 90 fixed bridge across the navigable waterway, West Pearl River, Mile 7.9, near White Kitchen, St. Tammany Parish, LA.

WATERWAY AND LOCATION: West Pearl River, US 90, Mile 7.9, St. Tammany Parish, Louisiana.

CHARACTER OF WORK: LA DOTD proposes to replace the existing vertical lift bridge with a new bridge. The existing vertical lift bridge was closed to traffic and can no longer be used due to deterioration in the bridge's structural elements. The existing bridge will be removed in its entirety. The proposed bridge will consist of concrete girder spans.

MINIMUM NAVIGATIONAL CLEARANCES:

	Existing	Proposed
Vertical	In the closed position – 10.85' clearance above Mean High Water In the open position – 50' clearance above Mean High Water	Fixed 12' clearance above Mean High Water
Horizontal	90' clearance	60' clearance

SOLICITATION OF COMMENTS: Interested parties are requested to comment or express their views in writing on the proposed navigation clearances and other navigational safety issues, including the need for clearance gauges.

Comments can be sent to LA DOTD Environmental Section at the address below postmarked no later than November 14, 2022 or emailed to Stacie.Palmer@LA.GOV no later than November 14, 2022. Sketches of the proposed bridge are included in this public notice.

LADOTD, Environmental Section 28
P.O. Box 94245
Baton Rouge, LA 70804-9245
ATTN: Stacie Palmer
SUBJECT: West Pearl River Navigational Clearance

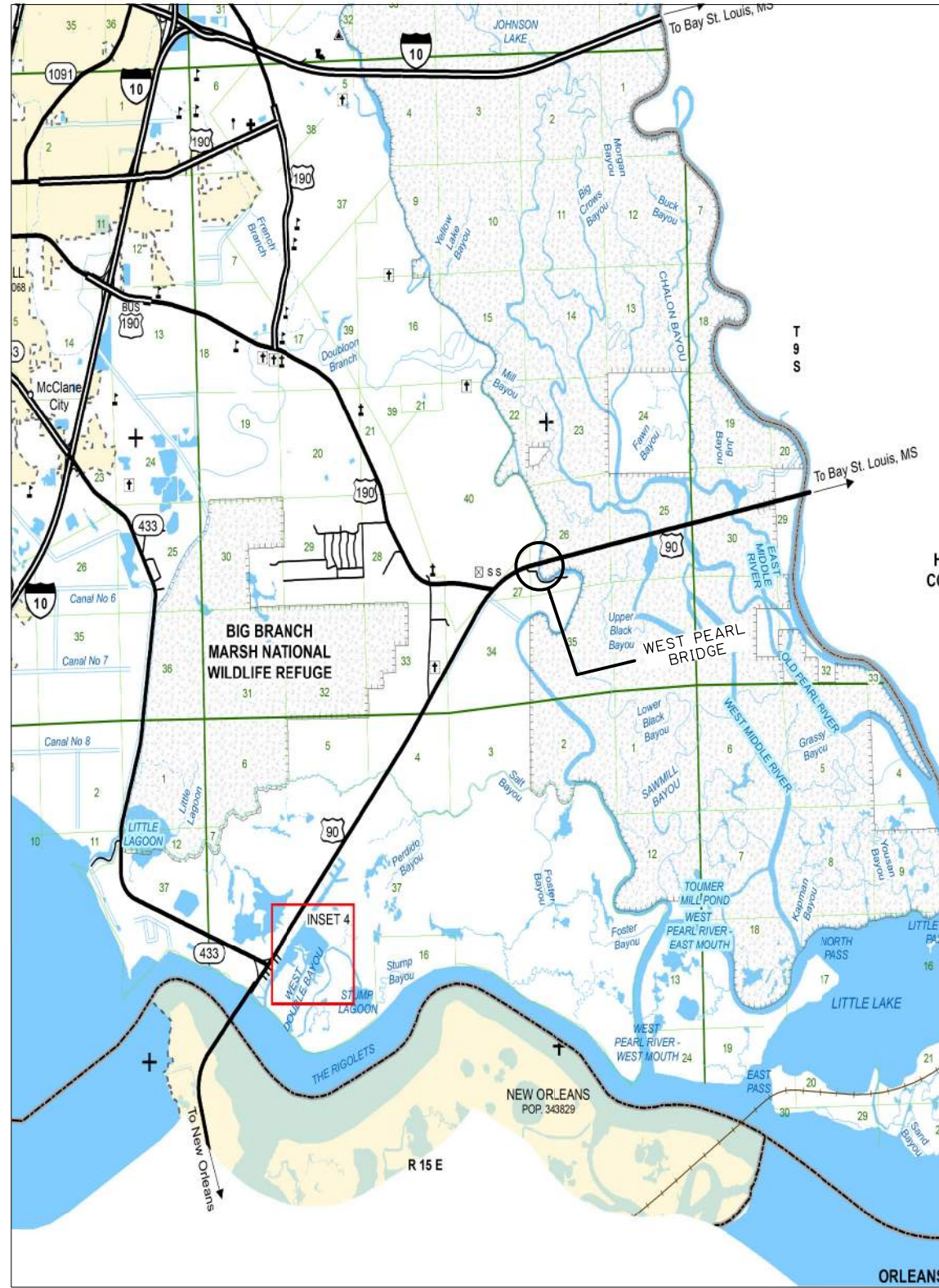

PARISH MAP



VICINITY MAP



LAYOUT MAP



SHEET NUMBER	
PARISH	ST. TAMMANY
DESIGN CHECK	A. BURNOS
DETAIL CHECK	A. MICHAEL
REVIEW	
CONTROL SECTION	
STATE PROJECT	H.015138
SERIES	1 OF 2

PRELIMINARY FOR REVIEW ONLY

ENGINEER:
ANDREW MICHAEL

LICENSE #:
37620

DATE:
10/5/2022

NO.	DATE	REVISION OR CHANGE ORDER DESCRIPTION	BY



WEST PEARL BRIDGE
VICINITY AND LAYOUT MAPS



08:15

10/5/2022

IP_PWP:d0273065\106 General Plan West Pearl Bridge.dgn.dgn

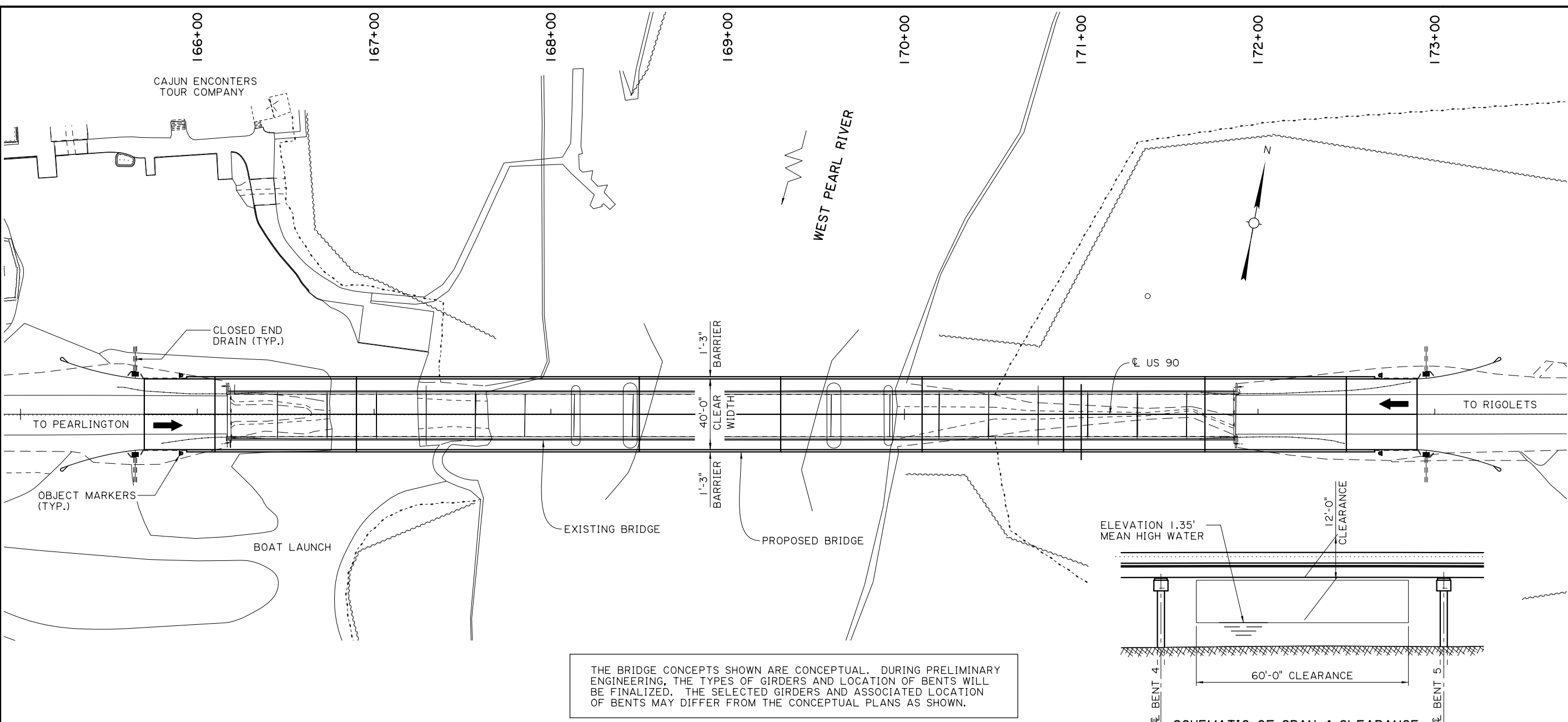

THE BRIDGE CONCEPTS SHOWN ARE CONCEPTUAL. DURING PRELIMINARY ENGINEERING, THE TYPES OF GIRDERS AND LOCATION OF BENTS WILL BE FINALIZED. THE SELECTED GIRDERS AND ASSOCIATED LOCATION OF BENTS MAY DIFFER FROM THE CONCEPTUAL PLANS AS SHOWN.

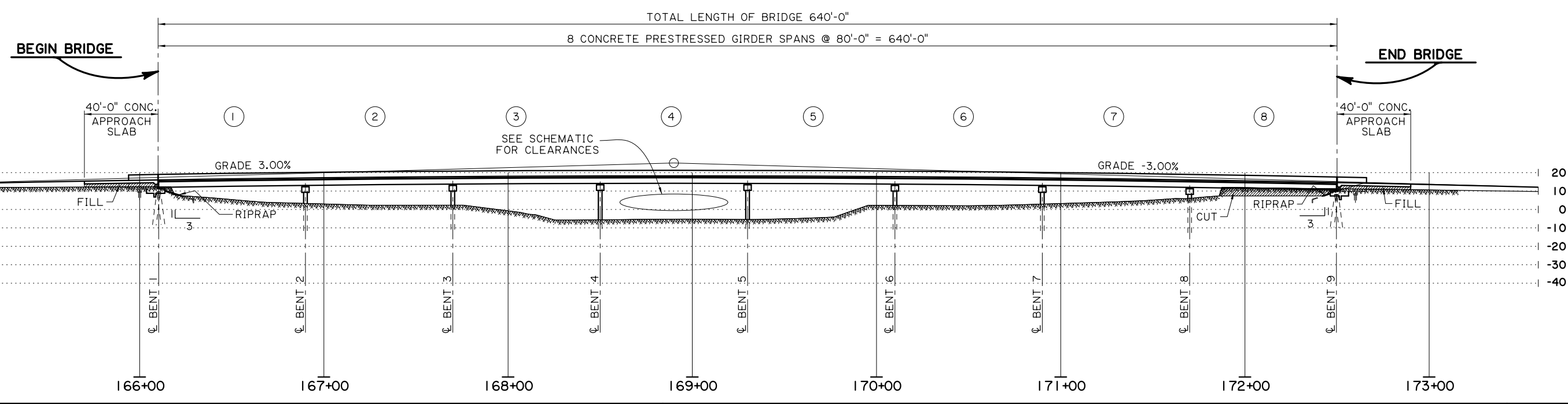
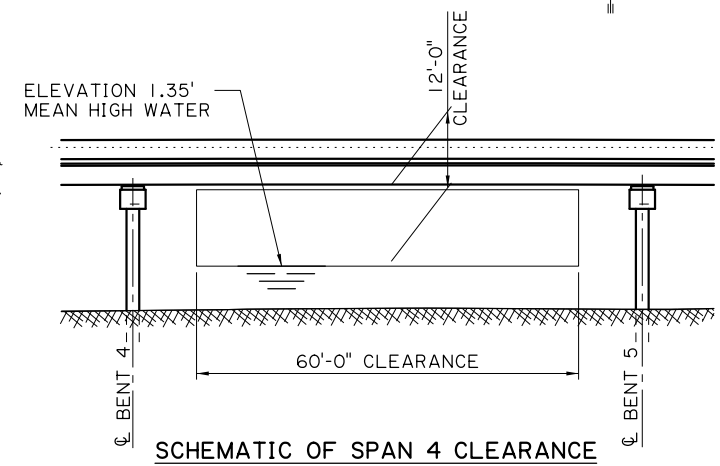

SHEET NUMBER		ST. TAMMANY	
DESIGN CHECK	A. BURROS	CONTROL SECTION	A. MICHAEL
REVIEW	A. MICHAEL	STATE PROJECT	H.015158
SERIES # 2 OF 2			

PRELIMINARY FOR REVIEW ONLY

ENGINEER: ANDREW MICHAEL

LICENSE #: 37620

DATE: 10/5/2022

NO.	DATE	REVISION OR CHANGE ORDER DESCRIPTION	BY

STATE OF LOUISIANA

BRIDGE GENERAL PLAN
WEST PEARL BRIDGE

DOTD
LOUISIANA DEPARTMENT OF TRANSPORTATION & DEVELOPMENT

BRIDGE AND STRUCTURAL DESIGN